

PCBA LAYOUT

- NOTES:
 1.MATERIAL:
 1.1 HOUSING: PA9T
 1.2 DIELECTRIC: LCP
 1.3 SHELL: ZAMAK3.
 1.4 CONTACT: BRASS
 1.5 BAFFLE: STAINLESS STEEL

- 2.FINISH:
 CONTACT:
 CONTACT: SEE ORDER INFORMATION.
 UNDERPLATING:50~100u" NICKEL OVERALL
 SHELL:120u"~240u" MATTE TIN
 3.SPEC. PLS. REFER TO PS-92805-XXXXX-XXX.
 4.PACKAGE PLS. REFER TO 92805-001CR-XX.
 5.PART NUMBER:

92805-001 X X-XXX
 CKTS ——— CAZ
 PACKING ——— PLATING
 0:TAPE & REEL 1: 6u" GOLD

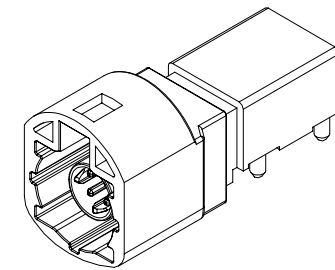

QUALITY SYMBOLS MAJOR Ⓢ CRITICAL Ⓢ GENERAL TOLERANCES (UNLESS SPECIFIED) X. ±0.15 .X ±0.10 .XX ±0.05 .XXX ±0.02 ANGLES ±1°	DRAWN BY Chen Chih Wei	DATE 21' / 04 / 07			
	CHECKED BY Lee Kuang En	DATE 21' / 04 / 07			TITLE HSD MALE CONN.T/H R/A SINGLE TYPE
	APPROVED BY Chen Chi Chang	DATE 21' / 04 / 07	UNITS mm		SIZE A4
	SCALE 1 : 1	SHEET NO. 1 OF 1	REV A	DWG NO. 92805-001XX-XXX	R/Q NO. NA