

RECOMMENDED PCB LAYOUT (TOP VIEW)  
(TOLERANCE=±0.05mm ; THICKNESS=0.8~1.2t)

- NOTES:
1. MATERIAL: SEE TABLE
  2. PLATING:  
CONTACT: NI 50u" MIN. UNDERPLATING OVER ALL, GOLD FLASH ON CONTACT AREA, MATT-TIN 60u" ON SOLDER AREA.  
SHELL: NICKEL PLATED 60u" MIN.
  3. ELECTRICAL CHARACTERISTICS:  
3-1.RATING: DC 20V/20A (OVER AMBIENT ΔT: 30°C MAX.)  
3-2.CONTACT: RESISTANCE: 10mΩ MAX.(INITIAL)  
15mΩ MAX.(AFTER LIFT TEST)  
3-3.DIELECTRIC WITHSTANDING VOLTAGE: 500V AC FOR ONE MINUTE.  
3-4.INSULATION RESISTANCE: 100MΩ MIN. MEASURED BY 500V DC.
  4. MATING / UNMATING FORCE:  
INITIAL: 0.8~3.5 KG  
AFTER: 0.6~3.5 KG
  5. LIFT TEST: 8000 CYCLES.
  6. SPEC. PLS. REFER TO SPEC-56910-XXXXX-XX1
  7. PACKAGE PLS. REFER TO 56910-000XX-XXX-PCK
  8. PART NUMBER:

56910-000 X X -X X 1  
C/H:+0.0

1: 20A  
0: WITHOUT MYLAR  
1: WITH MYLAR  
0: NONE

PLATING:  
2: GOLD FLASH

PACKING:  
0: TAPE & REEL

9. DATE CODE:

YEAR: 0=2010 (0~9), 2020=A (B.C.D.....)  
MONTH: A(JAN), B(FEB).....  
DAY: 08=8TH

T=MADE IN TAIWAN  
D=MADE IN DONGGUAN  
E=MADE IN KUNSHAN-YANGTZE  
K=MADE IN KUNSHAN-QINGYANG  
G=MADE IN CHONGQING

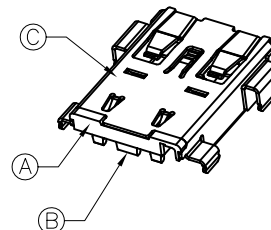
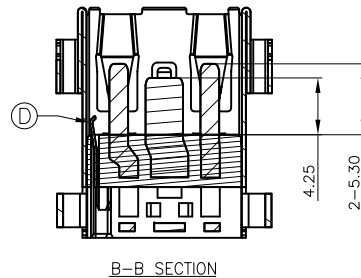
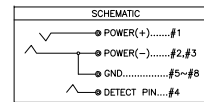
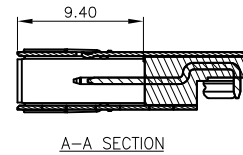
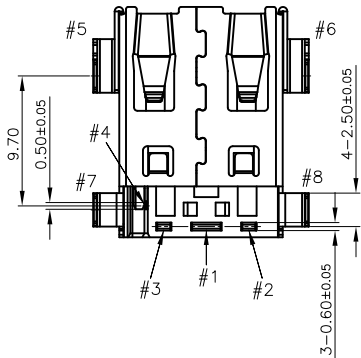
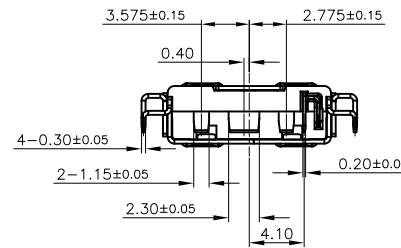
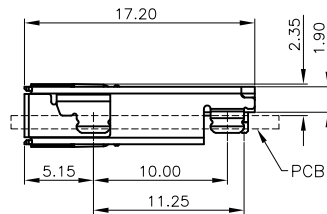
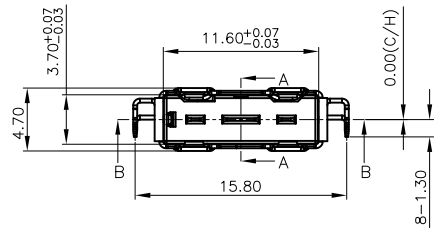

P/N	PIN DEFINE
#1	POWER (+)
#2,#3	POWER (-)
#4	DETECT PIN
#5~#8	GND

NO	DESCRIPTION	Q'TY	MATERIAL	PLATING & COLOR
D	DETECT PIN	1	SUS304-1/2H, 0.20t	SEE NOTES.
C	SHELL	1	SUS304-1/4H, 0.30t	SEE NOTES.
B	CONTACT	3	C18400, 0.60t	SEE NOTES.
A	HOUSING	1	PA9T+45%GF, UL94V-0	BLACK

QUALITY SYMBOLS		DRAWN BY	DATE	
MAJOR	CRITICAL	Ko, meng hsun	21/06/08	
GENERAL TOLERANCES ( UNLESS SPECIFIED )		CHECKED BY	DATE	<b>BOXING POWER JACK 400W</b> ( CH : +0.00 )
X. ±0.5	.X ±0.25	Chang, chun te	21/06/08	
.XX ±0.15	.XXX ±0.1	APPROVED BY	DATE	UNITS
ANGLES ±2°		Kuo, rong hsun	21/06/08	mm
				SCALE
				1 OF 2
				SHEET NO.
				1 OF 2
				SIZE
				A4
				REV
				D
				RFG NO.
				---
				DWG NO.
				56910-000XX-XX1

1. GROUND CONTACT STATUS

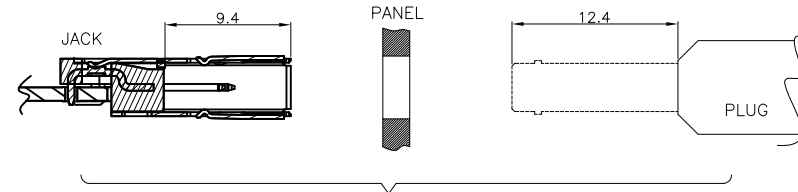
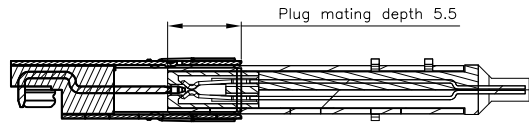

2. POWER (-) CONTACT STATUS

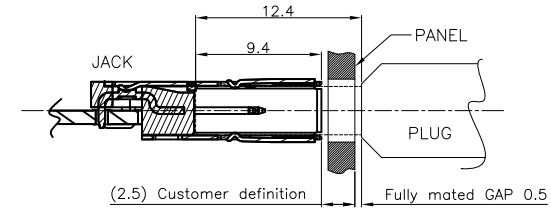
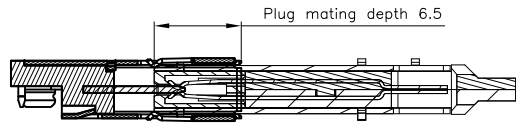

3. POWER (+) CONTACT STATUS

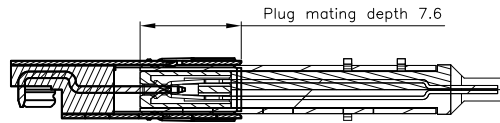

**Example :**  
**Plug Length 12.4 - Jack Mating depth 9.4 - Customer definition 2.5 = GAP 0.5**

REFERENCE MATING DRAWING

4. DETECT CONTACT STATUS

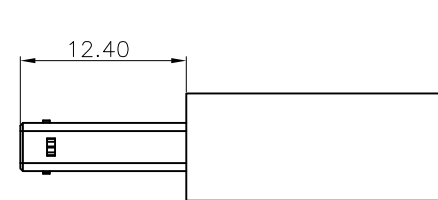
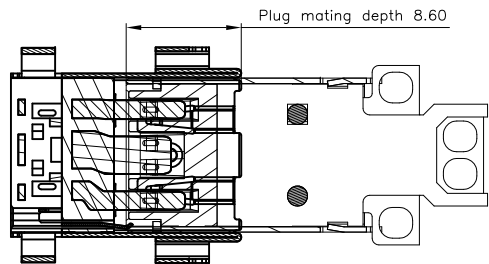

RECOMMENDED MATING PLUG  
 (ACES 56911-00622-001)

REFERENCE OVERMOLDING DRAWING

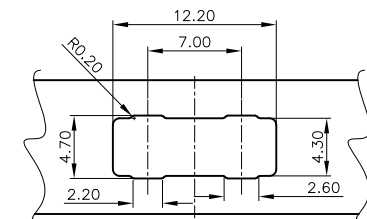

RECOMMENDED PANEL  
 (TOLERANCE=±0.05mm)

5. LOCKED STATUS

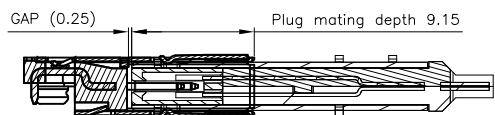

QUALITY SYMBOLS MAJOR Ⓜ CRITICAL Ⓢ GENERAL TOLERANCES ( UNLESS SPECIFIED ) X. ±0.5 .X ±0.25 .XX ±0.15 .XXX ±0.1 ANGLES ±2°	DRAWN BY Ko, meng hsun	DATE 21/06/08	
	CHECKED BY Chang, chun te	DATE 21/06/08	
	APPROVED BY Kuo, rong hsun	DATE 21/06/08	RFG NO. ---
	UNITS mm		SIZE A4
	SCALE - : -	SHEET NO. 2 OF 2	REV D
			DWG NO. 56910-000XX-XX1