

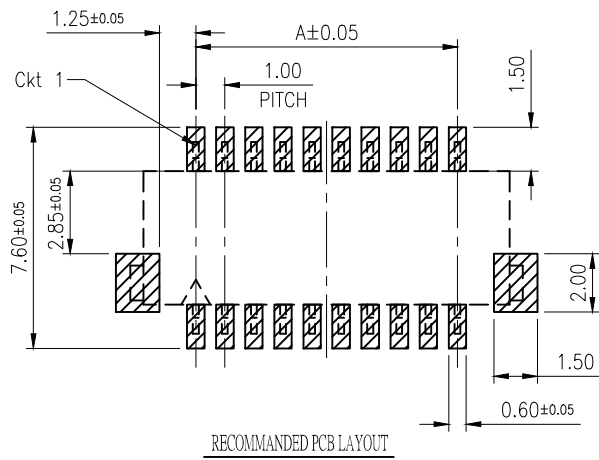

Ckt 1

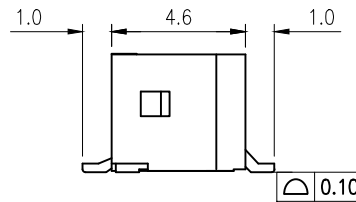
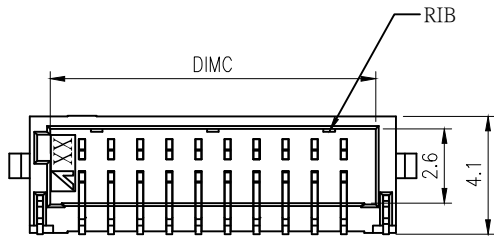
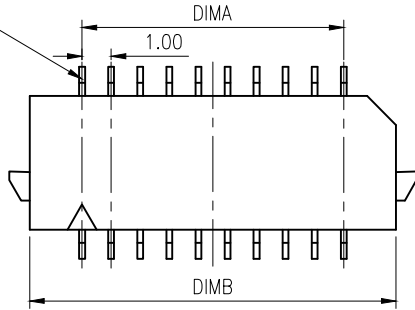

RECOMMENDED PCB LAYOUT

NOTES:

1. MATERIAL:
 - 1.1 HOUSING: THERMOPLASTIC, HIGH TEMP.,UL94V-0. COLOR:NATURAL.
 - 1.2 CONTACT: COPPER ALLOY.
 - 1.3 FITTING NAIL: COPPER ALLOY
2. FINISH:
 - 2.1 CONTACT:
 - 50~100u" NICKEL UNDERPLATING OVERALL.
 - 1:GOLD FLASH PLATING OVERALL
 - 2.2 FITTING NAIL:
 - 50~100u" NICKEL UNDERPLATING OVERALL.
 - N:120u" MIN MATT TIN PLATING ON OVER ALL.
3. REFLOW SOLDER CAPABLE TO 260°C PER ACES SPEC.
4. SPEC.PLS REFER TO PS-51291-XXXX-XXX
5. PACKAGE PLS REFER TO 51291-XXXX-XX-TRP
6. PART NUMBER

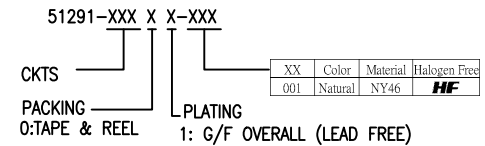

CKTS	DIM A	DIM B	DIM C	RIB
6	2.0	5.6	4.2	NO
12	5.0	8.6	7.2	NO
24	11.0	14.6	13.2	YES
40	19.0	22.6	21.2	YES

QUALITY SYMBOLS	DRAWN BY	DATE	ACES ELECTRONICS	
MAJOR	ZHANGHAO	2020/04/01		
CRITICAL	CHECKED BY	DATE	TITLE	
GENERAL TOLERANCES (UNLESS SPECIFIED)	XUZHIYONG	2020/04/01		
X. ±0.5	APPROVED BY	DATE	1.0mm WTB WAFER R/A D/R SMT TYPE	
.X ±0.25	XUZHIYONG	2020/04/01		
.XX ±0.15	UNITS	SIZE	RFG NO.	
.XXX ±0.1	mm		A4	N/A
ANGLES ±2°	SCALE	SHEET NO.	REV	DWG NO.
	1:1	1 OF 1	C	51291-XXXX-XXX