

RECOMMENDED PCB LAYOUT
GENERAL TOLERANCE ± 0.05

NOTES:

1. MATERIAL:

- 1.1 HOUSING: THERMOPLASTIC, HIGH TEMP., UL94V-0; COLOR:NATURAL.
- 1.2 CONTACT: COPPER ALLOY
- 1.3 COVER: THERMOPLASTIC, HIGH TEMP.UL94V-0; COLOR:BLACK.
- 1.4 MYLAR

2. FINISH:

- 2.1 CONTACT:
50u" MIN. NICKEL PLATING OVERALL
N: 80u" MIN. MATTE TIN ON CONTACT & SOLDER TAIL
C: 15u" GOLD ON CONTACT & 80u"MIN MATTE TIN ON SOLDER TAIL

- 3. REFLOW SOLDER CAPABLE TO 260°C PER ACES SPEC.
- 4. SPEC. PLS. REFER TO PS-50961-XXXX-XXX
- 5. PACKAGE PLS. REFER TO 50951-008CR-00

6. PART NUMBER

50951-XXX X X-XXX
 CKTS _____ X _____ 001: NONE
 008: 8 PIN _____ PLATING
 PACKING _____ N: 80u" MIN. MATTE TIN ON CONTACT & SOLDER TAIL
 4: T&R WITH MYLAR C: 15u" GOLD ON CONTACT TAIL

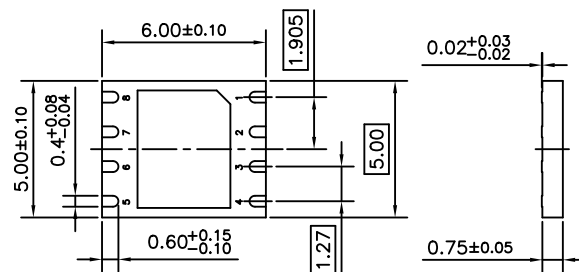
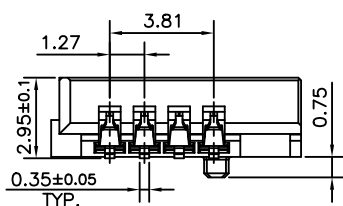
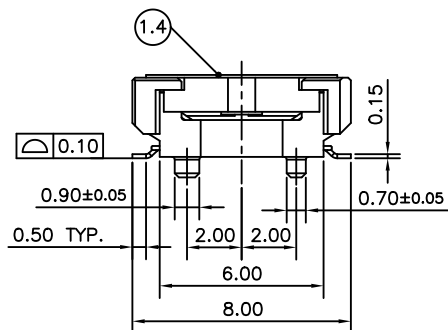

PAD CONFIGURATION LAYOUT

PIN DESCRIPTION	
PIN NO.	PIN NAME
1	/CS
2	DO
3	/WP
4	GND
5	DIO
6	CLK
7	/HOLD
8	VCC

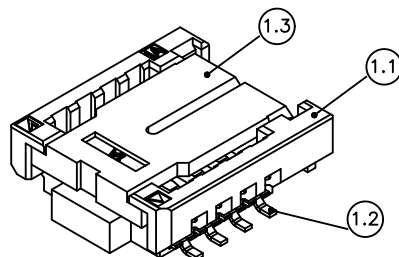

QUALITY SYMBOLS MAJOR Ⓢ CRITICAL Ⓢ	DRAWN BY Xu,Zhonglin 19/06/04	DATE 19/06/04	
GENERAL TOLERANCES (UNLESS SPECIFIED) X. ±0.5 .X ±0.25 .XX ±0.15 .XXX ±0.1 ANGLES ±2°	CHECKED BY Lu, Jing Qian 19/06/04	DATE 19/06/04	
	APPROVED BY hsieh, fu yu 19/06/04	DATE 19/06/04	SIZE A4
	UNITS mm	SCALE 4 : 1	RFQ NO. N/A
	SHEET NO. 1 OF 4	REV H	DWG NO. 50951-XXXX-XXX

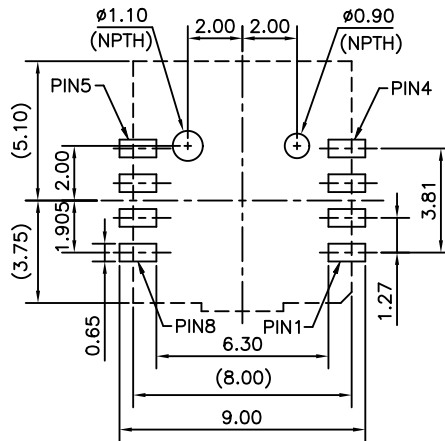
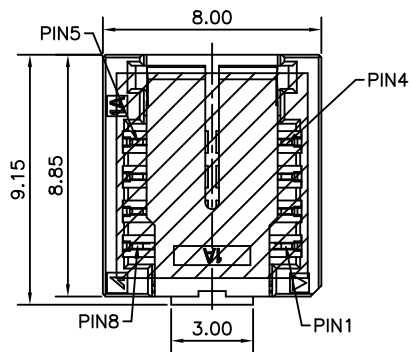

RECOMMENDED PCB LAYOUT
GENERAL TOLERANCE ± 0.05

NOTES:

1. MATERIAL:

- 1.1 HOUSING: THERMOPLASTIC, HIGH TEMP., UL94V-0; COLOR:NATURAL.
- 1.2 CONTACT: COPPER ALLOY
- 1.3 COVER: THERMOPLASTIC, HIGH TEMP.UL94V-0; COLOR:BLACK.
- 1.4 MYLAR

2. FINISH:

- 2.1 CONTACT: 50u" MIN. NICKEL PLATING OVERALL
- N: 80u" MIN. MATTE TIN ON CONTACT & SOLDER TAIL
- C: 15u" GOLD ON CONTACT & 80u"MIN MATTE TIN ON SOLDER TAIL

3. REFLOW SOLDER CAPABLE TO 260°C PER ACES SPEC.

4. SPEC. PLS. REFER TO PS-50961-XXXX-XXX

5. PACKAGE PLS. REFER TO 50951-008CR-00

6. PART NUMBER

50951-XXX X X-XXX
 CKTS: 002: Terminal contact point back 0.10mm
 008: 8 PIN
 PLATING
 N: 80u" MIN. MATTE TIN ON CONTACT & SOLDER TAIL
 C: 15u" GOLD ON CONTACT TAIL
 PACKING: 4: T&R WITH MYLAR

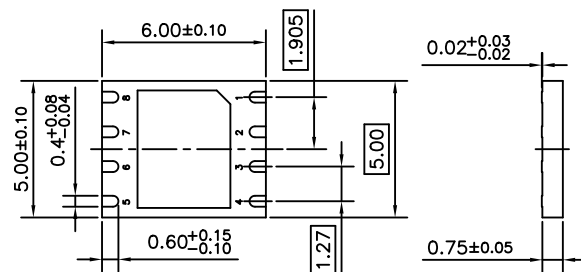
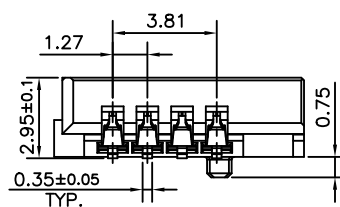
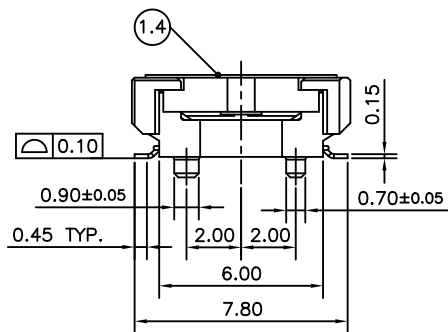

PAD CONFIGURATION LAYOUT

PIN DESCRIPTION	
PIN NO.	PIN NAME
1	/CS
2	DO
3	/WP
4	GND
5	DIO
6	CLK
7	/HOLD
8	VCC

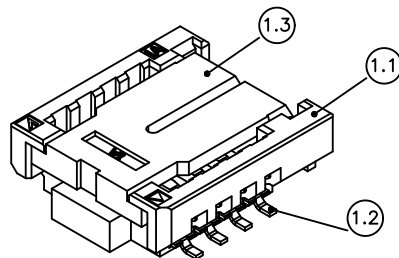

QUALITY SYMBOLS MAJOR Ⓢ CRITICAL Ⓢ	DRAWN BY Xu,Zhonglin 19/06/04	DATE 19/06/04			
GENERAL TOLERANCES (UNLESS SPECIFIED)	CHECKED BY Lu, Jing Qian 19/06/04	DATE 19/06/04			TITLE 1.27mm SPI ROM SOCKET SMT S/T TYPE
X. ± 0.5 .X ± 0.25 .XX ± 0.15 .XXX ± 0.1 ANGLES $\pm 2^\circ$	APPROVED BY hsieh, fu yu 19/06/04	DATE 19/06/04	UNITS mm	SIZE A4	RFG NO. N/A
	SCALE 4 : 1	SHEET NO. 2 OF 4	REV H	DWG NO. 50951-XXXX-XXX	

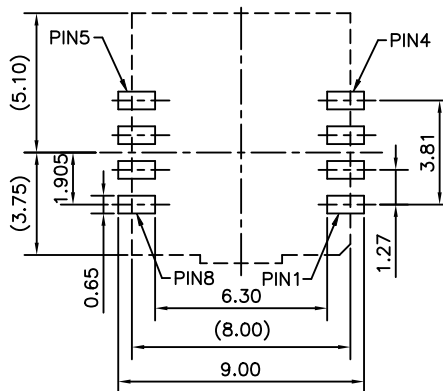
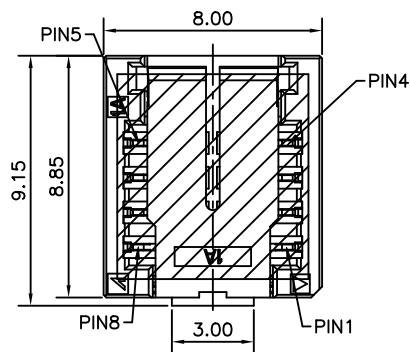

RECOMMENDED PCB LAYOUT
GENERAL TOLERANCE ± 0.05

NOTES:

1. MATERIAL:

- 1.1 HOUSING: THERMOPLASTIC, HIGH TEMP., UL94V-0; COLOR:NATURAL.
- 1.2 CONTACT: COPPER ALLOY
- 1.3 COVER: THERMOPLASTIC, HIGH TEMP.UL94V-0; COLOR:BLACK.
- 1.4 MYLAR

2. FINISH:

- 2.1 CONTACT:
50u" MIN. NICKEL PLATING OVERALL
N: 80u" MIN. MATTE TIN ON CONTACT & SOLDER TAIL
C: 15u" GOLD ON CONTACT & 80u"MIN MATTE TIN ON SOLDER TAIL

3. REFLOW SOLDER CAPABLE TO 260°C PER ACES SPEC.

4. SPEC. PLS. REFER TO PS-50961-XXXX-XXX

5. PACKAGE PLS. REFER TO 50951-008CR-00

6. PART NUMBER

50951-XXX X X-XXX
 CKTS: 008: 8 PIN
 PACKING: 4: T&R WITH MYLAR
 003: Terminal contact point back 0.10mm Without Boss
 PLATING
 N: 80u" MIN. MATTE TIN ON CONTACT & SOLDER TAIL
 C: 15u" GOLD ON CONTACT TAIL

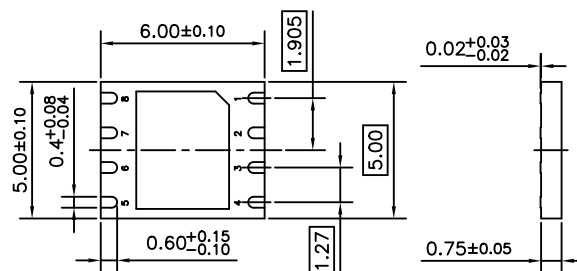
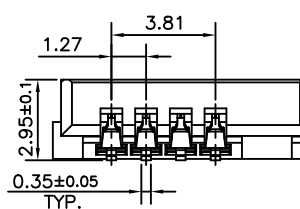
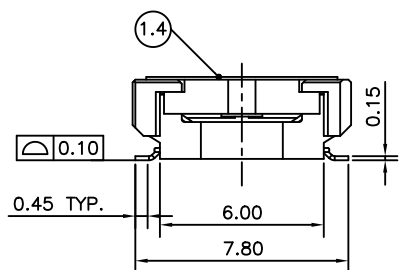

PAD CONFIGURATION LAYOUT

PIN DESCRIPTION	
PIN NO.	PIN NAME
1	/CS
2	DO
3	/WP
4	GND
5	DIO
6	CLK
7	/HOLD
8	VCC

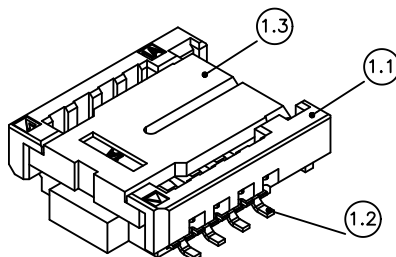

QUALITY SYMBOLS MAJOR Ⓢ CRITICAL Ⓢ	DRAWN BY Xu,Zhonglin 19/06/04	DATE 19/06/04	
GENERAL TOLERANCES (UNLESS SPECIFIED)	CHECKED BY Lu, Jing Qian 19/06/04	DATE 19/06/04	
X. ± 0.5 .X ± 0.25 .XX ± 0.15 .XXX ± 0.1 ANGLES $\pm 2^\circ$	APPROVED BY hsieh, fu yu 19/06/04	DATE 19/06/04	TITLE 1.27mm SPI ROM SOCKET SMT S/T TYPE
UNITS mm	SCALE 4 : 1	SHEET NO. 3 OF 4	SIZE A4 RFG NO. N/A
		REV H	DWG NO. 50951-XXXX-XXX

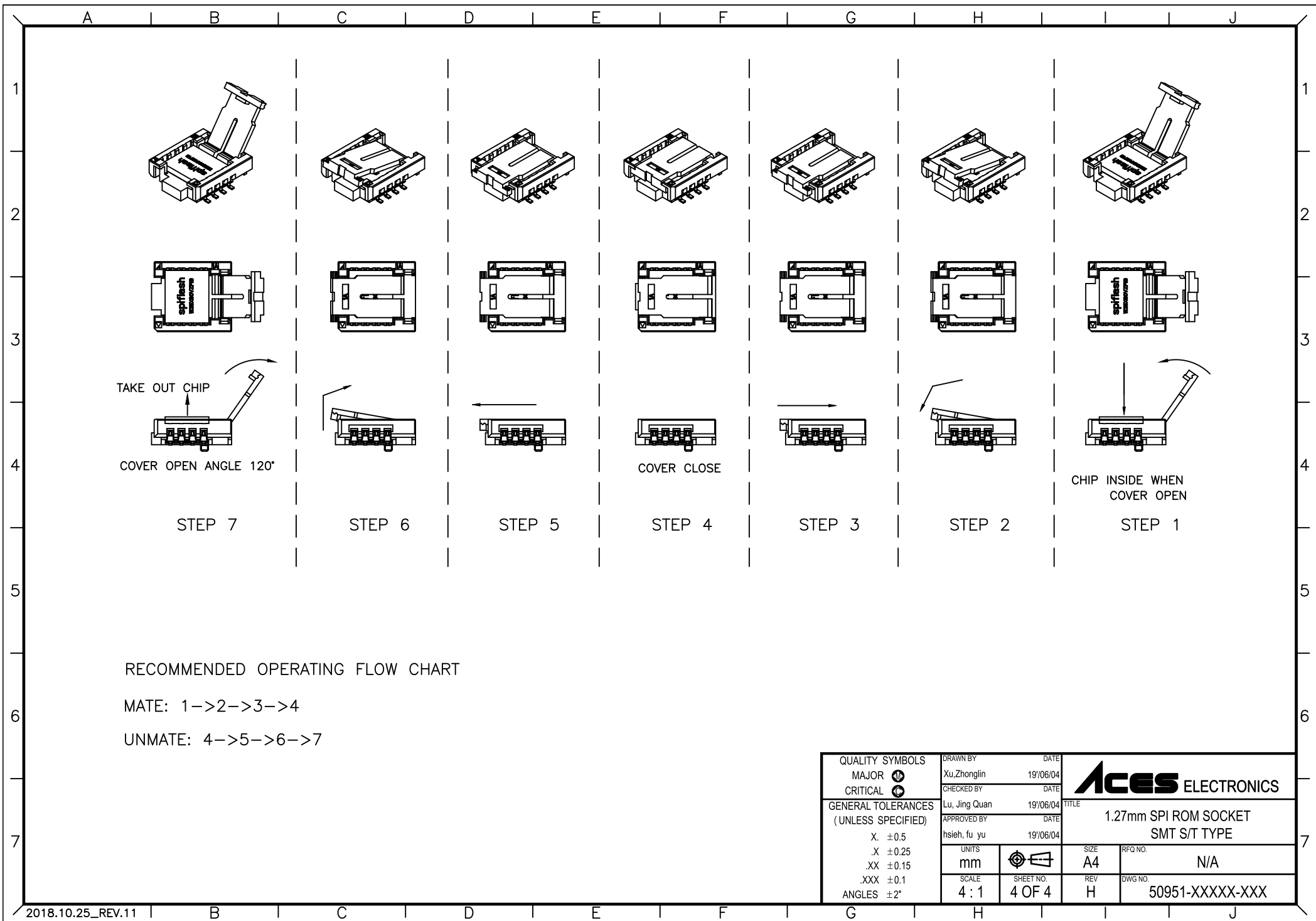

RECOMMENDED OPERATING FLOW CHART

MATE: 1->2->3->4

UNMATE: 4->5->6->7

QUALITY SYMBOLS MAJOR CRITICAL GENERAL TOLERANCES (UNLESS SPECIFIED) X. ±0.5 .X ±0.25 .XX ±0.15 .XXX ±0.1 ANGLES ±2°	DRAWN BY Xu,Zhonglin	DATE 19/06/04		TITLE 1.27mm SPI ROM SOCKET SMT S/T TYPE
	CHECKED BY Lu, Jing Quan	DATE 19/06/04		
	APPROVED BY hsieh, fu yu	DATE 19/06/04	UNITS mm	SCALE 4 : 1
				SIZE A4
			SHEET NO. 4 OF 4	REV H
				DWG NO. 50951-XXXXX-XXX