

REV.	DESCRIPTION	DRAWN	ECN	DATE
A	NEW RELEASE (3002-8043)	TINA	08-134	05-29'2008
B	SEE ECN (3007-9002)	Ken	09-002	01-06'2009
C	Add Recommended PCB Layout	Ken	N17-089	10-12'2017

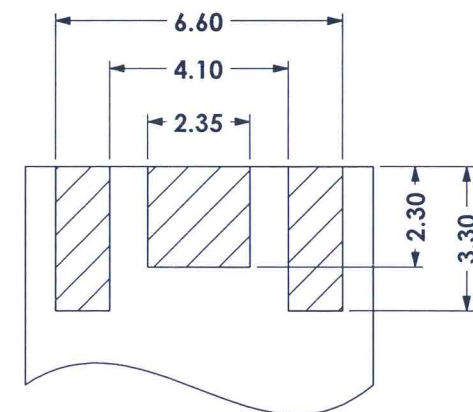

RECOMMENDED PCB LAYOUT
=====

ELECTRICAL RATINGS :
 1.Impedance : 50 ohms
 2.Frequency Range : 0~6 GHz
 3.Dielectric Withstanding Voltage : 1000 Vrms Maximum

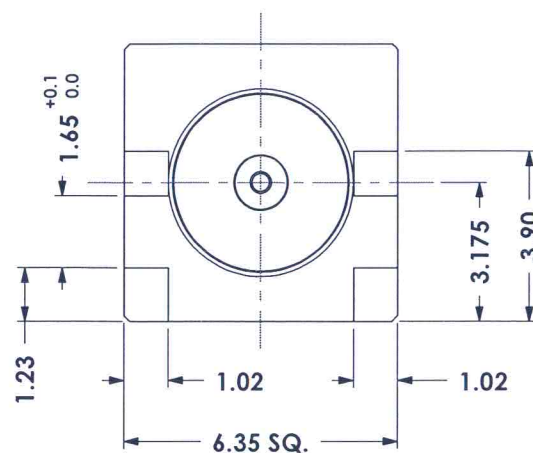
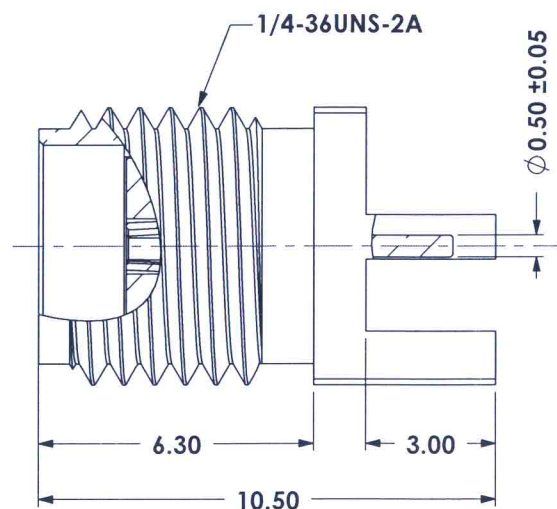
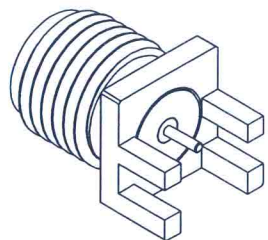

INSULATOR	PTFE	NATURAL
CONTACT	BE-COPPER	GOLD
BODY	BRASS	GOLD
DESCRIPTION	MATERIAL	FINISHED

RoHS

COMPLIANT

2011/65/EU

UNLESS OTHERWISE SPECIFIED ALL TOLERANCES ARE :

DIMENSION		ANGLE	
INTEGRAL DIMENSIONS	±1.0	ANGULAR DIMENSIONS	±5.0°
1 PLACE DECIMAL	±0.5	HOLES UNDER Ø0.5	±0.1
2 PLACE DECIMALS	±0.25	ROUGHNESS	

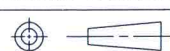

FINISH:

SEE TABLE

MATERIAL:

SEE TABLE

nicon Precise Corp.

DRAWN BY:	Zeke	DATE:	05-26'2008
CHK BY:	25	DATE:	10/2'2017
APVD BY:	249	DATE:	2017.10.12

TITLE: SMA ST. JACK EDGE MOUNT RECEPTACLE

Model NO: 21045

Drawing NO: 12-21045

UNIT:	MM	SIZE:	A4	REV.	C	CAD FILE:	
SCALE:	6 : 1	SHEET	1 OF 1			New dwg/21XXX/21045	