

PROPRIETARY INFORMATION
COMPANY CONFIDENTIAL

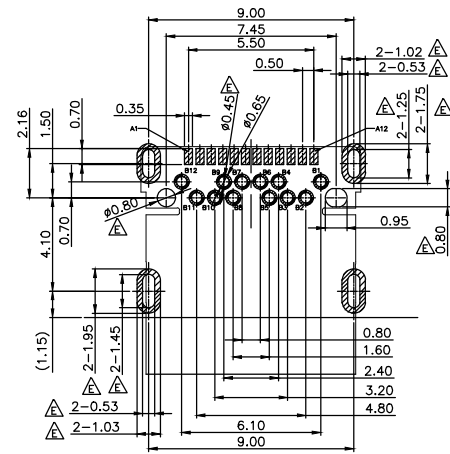

REV.	ECN. NO.	DESCRIPTION	ENG	DATE
A		INITIAL	Knight	2/2/16'
B		UPDATE DRAWING	Ethan	4/28/20'
C		UPDATE NOTE	Ethan	5/13/20'
D		ADD PRODUCT OPTION	Ethan	7/16/20'
E		ADD TOLERANCE	Ethan	7/22/20'

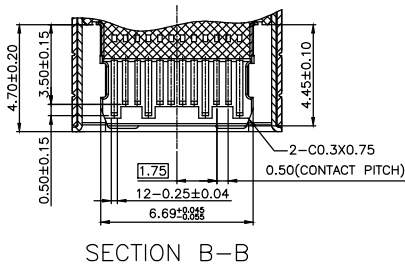
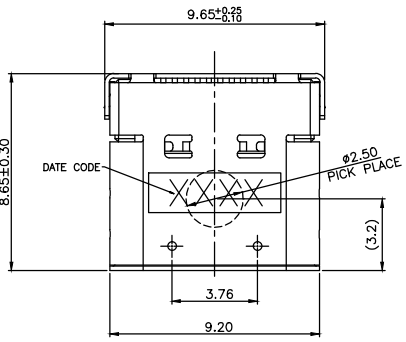

RECOMMEND P.C.B LAYOUT (COMPONENT SIDE)
TOLERANCE FOR PCB LAYOUT IS ± 0.05
KEEP OUT AREA

- NOTE:
- MATERIAL:
 - 1.1 INSULATOR: LCP 130i; UL94 V-0; Black Color
 - 1.2 CONTACT: COPPER ALLOY
 - 1.3 SHELL: STAINLESS STEEL
 - 1.4 COVER SHELL: STAINLESS STEEL
 - 1.5 INNER GROUND COVER SHELL: STAINLESS STEEL
 - 1.6 MID PLATE: STAINLESS STEEL
 - ELECTRICAL CHARACTERISTICS:
 - 2.1 CONTACT RESISTANCE: 40mΩ Max FOR INITIAL. 10mΩ CHANGE AFTER TEST. MEASURE AT 20mV, 100mA.
 - 2.2 CONTACT CURRENT RATING: 5A FOR COLLECTIVELY POWER SUPPLY PIN (PINA1,A4,A9,A12,B1,B4,B9,B12); 1.25A FOR V_{COMMON} PIN;
 - 2.3 DIELECTRIC WITHSTANDING VOLTAGE: 100V AC R.M.S.
 - 2.4 INSULATION RESISTANCE: 100MΩ Min.
 - 2.5 OPERATING TEMPERATURE: -40°C ~ 85°C
 - 2.6 PIN AND PASTE COMPATIBLE
 - MECHANICAL CHARACTERISTICS:
 - 3.1 MATING FORCE: 5~20 N.
 - 3.2 UNMATED FORCE: 6~20N AFTER TEST
 - 3.3 DURABILITY: 10,000 CYCLES
 - PLATING:
 - 4.1 TERMINAL CONTACT: G/F PLATING ON CONTACT AREA, ALL OVER 50u" Min NICKEL AND 80u" Min Matte Tin ALL OVER 50u" Min NICKEL ON SOLDER AREA
 - 4.2 SHELL: 50u" Min. NICKEL ALL OVER,
 - 4.3 COVER SHELL: 80u" Min. NICKEL ALL OVER,
 - 4.4 INNER GROUND COVER SHELL: 50u" Min. NICKEL ALL OVER,
 - 4.5 MID PLATE: CLEAN

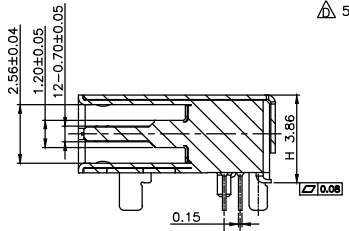
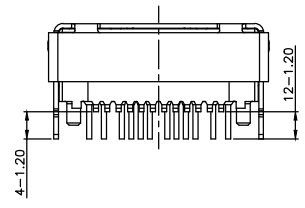
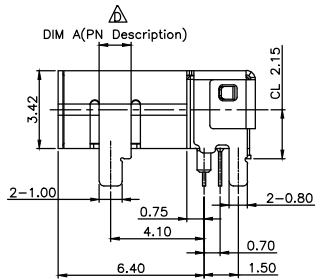
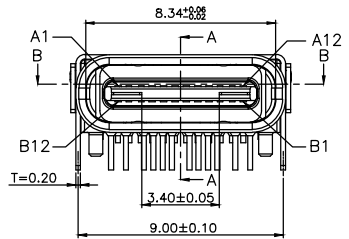

SECTION A-A

5. PART NUMBER
210-10017-XX
- 01: DIM A=1.40mm
 - 02: DIM A=1.80mm

Pin	Signal Name	Mating Sequence	Pin	Signal Name	Mating Sequence
A1	GND	First	B12	GND	First
A2	SSTXp1	Second	B11	SSRXp1	Second
A3	SSTXn1	Second	B10	SSRXn1	Second
A4	V _{BUS}	First	B9	V _{BUS}	First
A5	CC1	Second	B8	SBU2	Second
A6	Dp1	Second	B7	Dn2	Second
A7	Dn1	Second	B6	Dp2	Second
A8	SBU1	Second	B5	CC2	Second
A9	V _{BUS}	First	B4	V _{BUS}	First
A10	SSRXn2	Second	B3	SSTXn2	Second
A11	SSRXp2	Second	B2	SSTXp2	Second
A12	GND	First	B1	GND	First
SHELL	GND		SHELL	GND	

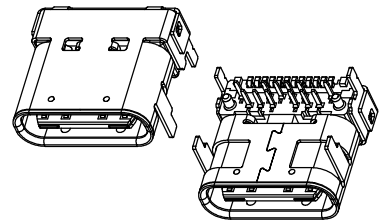
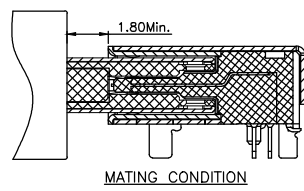
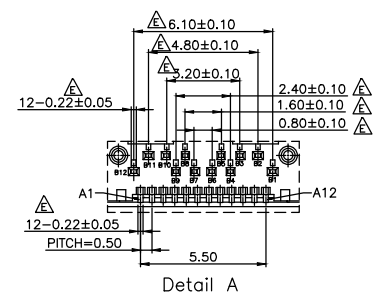
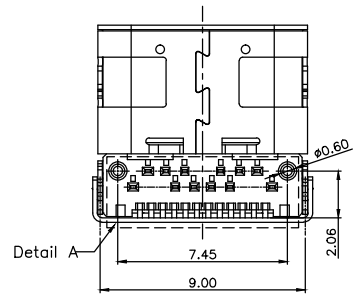

GENERAL TOLERANCE		ANGLE TOLERANCE	DRAWN	DATE
.X	± 0.30	±2°	Ethan	5/13/20'
.XX	± 0.20		CHECKED	DATE
.XXX	± 0.10		APPROVED	DATE
MATL	SEE BOM		Hill	5/13/20'
FINISH	SEE NOTES			
SCALE	N/A	UNIT	mm	
SHEET	1 OF 2			

genesis
connected solutions

TITLE: USB 3.1 C TYPE CL=2.15
H=3.86 G/F R/A SMT

PART NUMBER:
210-10017-XX

DRAWING NO.:
210-10017

SIZE A4
REV. E

PROPRIETARY INFORMATION
COMPANY CONFIDENTIAL



REV.	ECN. NO.	DESCRIPTION	ENG	DATE
		SEE SHEET 1		

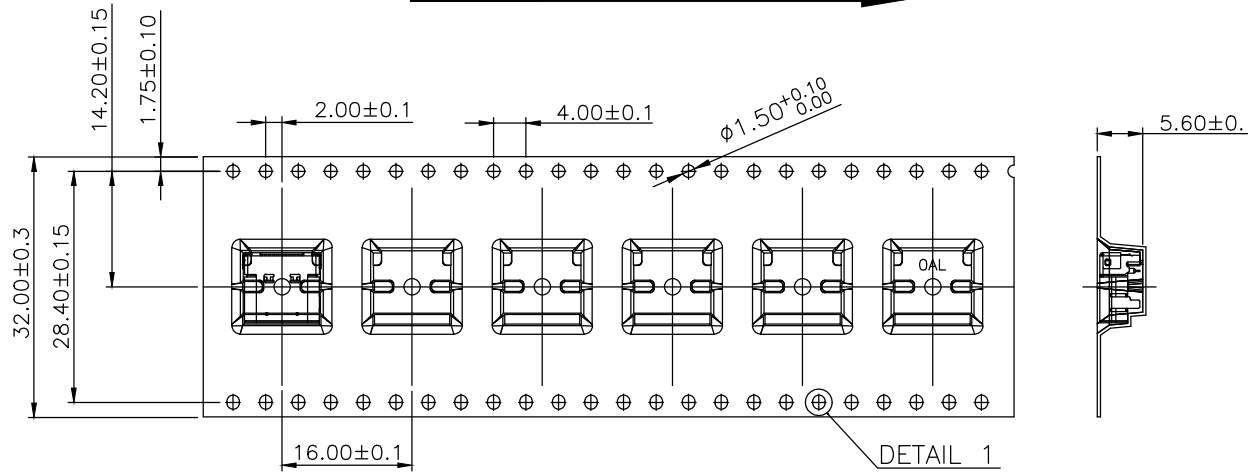
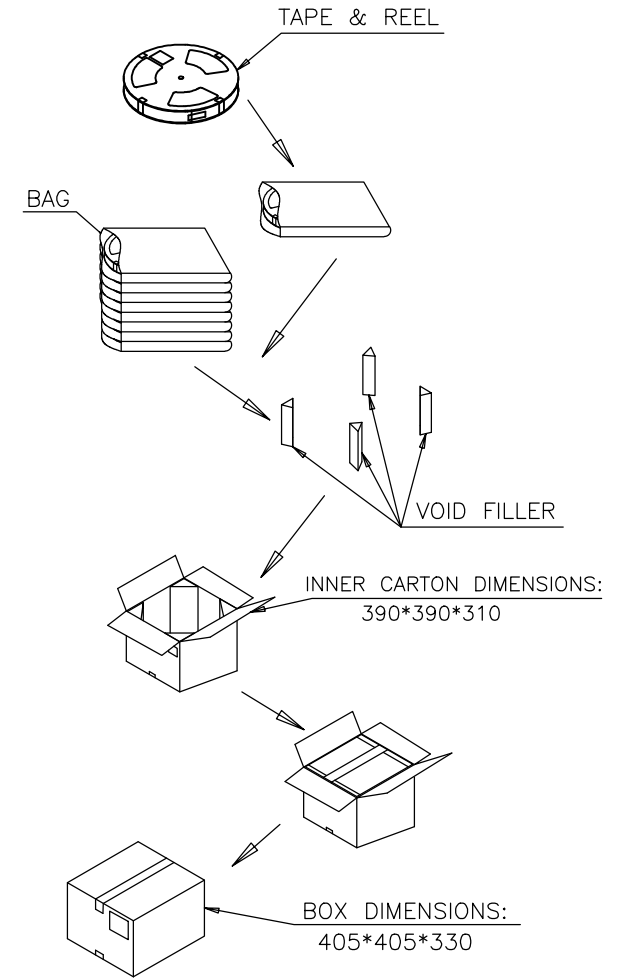
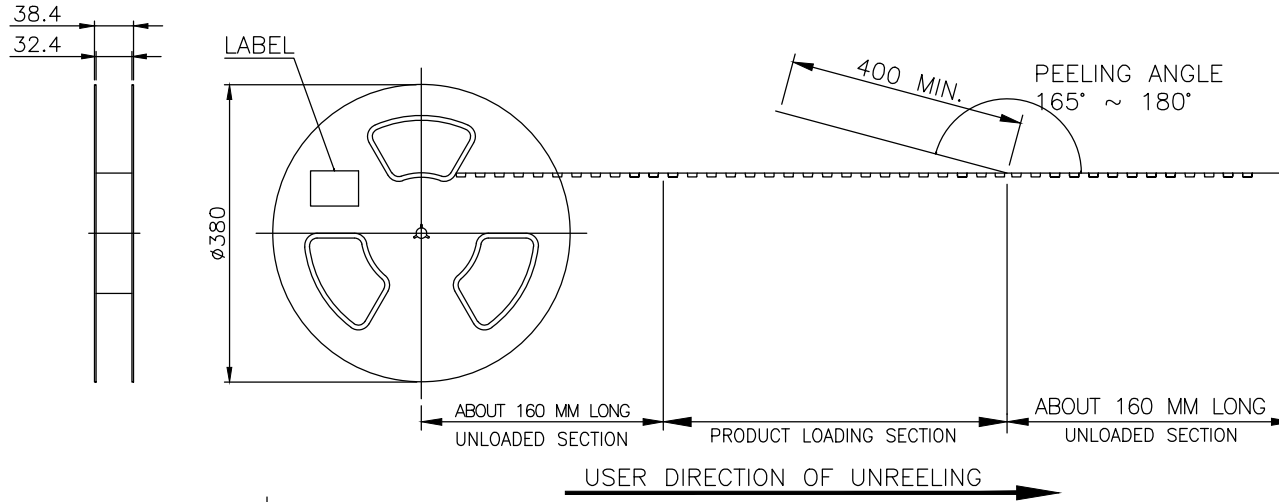

NOTE:

- 1.MATERIAL:
BOX: FIBREBOARD, CORRUGATED, DOUBLE WALL.
TAPE: POLYSTYRENES, HEAT-RESISTANT TEMPERATURE: 120°C, BLACK COLOR.
REEL: POLYSTYRENES, HEAT-RESISTANT TEMPERATURE: 70°C, BLUE COLOR.
BAG: POLYETHYLENE, HEAT-RESISTANT TEMPERATURE: 100°C.

2.PEELING STRENGTH: 0.1 ~ 1.3 N (10 ~ 130 GRAMS)

3.PEELING SPEED: 300 mm/min.

4.EACH BAG SHALL BE INCLUDED DESICCANT.

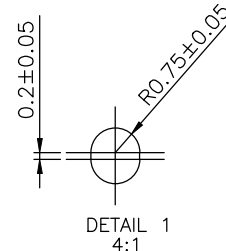

1000	8	8000 PCS	-- KG	-- KG
PCS/ REEL	REELS/ CARTON	QUANTITY	GROSS WEIGHT	NET WEIGHT

GENERAL TOLERANCE	ANGLE TOLERANCE	DRAWN	DATE	
.X ± 0.30 .XX ± 0.20 .XXX ± 0.10	±2°	Ethan	5/13/20'	
MATL	SEE BOM	CHECKED	DATE	TITLE. USB 3.1 C TYPE CL=2.15 H=3.86 G/F R/A SMT
FINISH	SEE NOTES	APPROVED	DATE	PART NUMBER. 210-10017-XX
SCALE N/A	UNIT mm	Hill	5/13/20'	DRAWING NO. 210-10017
SHEET 2 OF 2				SIZE A4 REV. E